

DAIKIN ONE LITE
CONNECTED THERMOSTAT

Homeowner Guide



DAIKIN *ONE* LITE
CONNECTED THERMOSTAT

Welcome! This homeowner guide features an overview of functions and/or features available through the Daikin *ONE* lite connected thermostat*.



*The *SkyportHome* app is the preferred means of accessing these features, but the instructions that follow are helpful even if the app is not used.



Create a *SkyportHome* app account

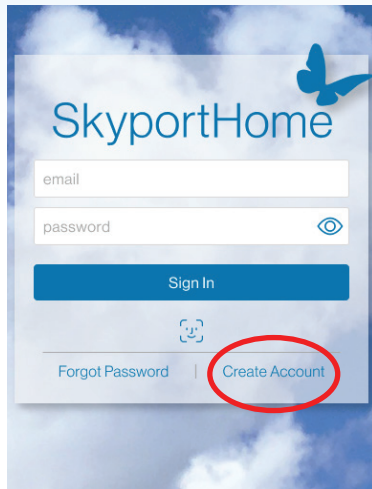

1. After installing the **SkyportHome** app from the App Store or Play Store, select "Create Account".

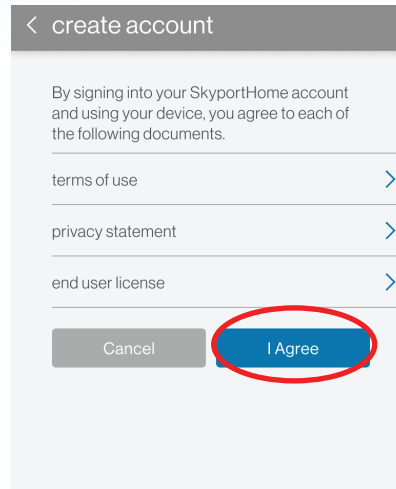

2. Review the documents and select "I Agree".

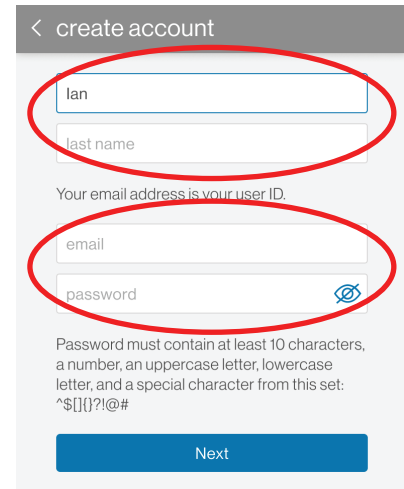

3. Enter your name, email address, and a password that meets the length and complexity requirements.

4. Check your email account for an email with your account verification code.

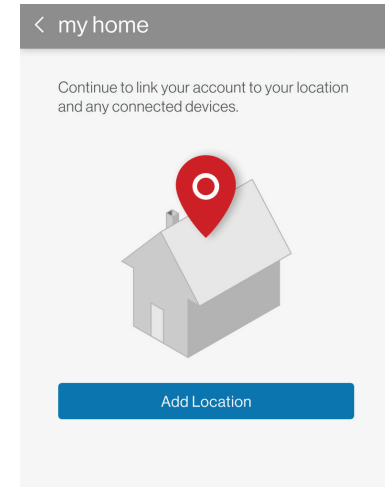
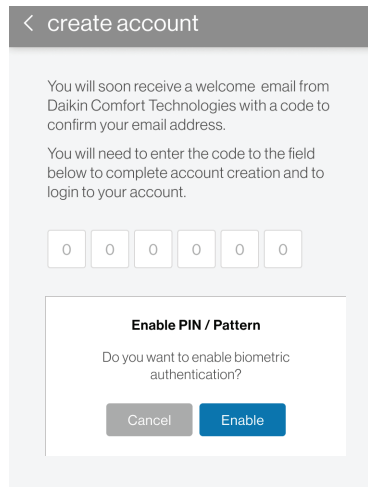
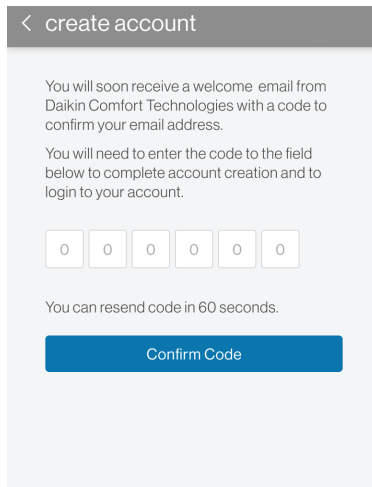
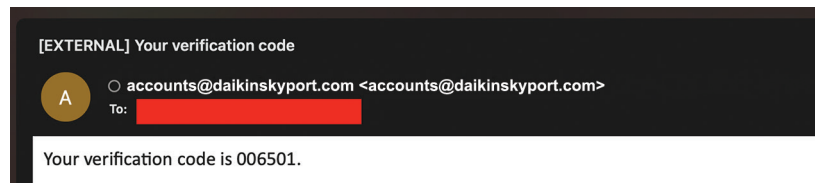

5. Enter the verification code in the app and select "Confirm Code". When successful, you will next be asked about enabling biometrics, and then navigated to the "my home" screen.



To learn more about operating the Daikin *ONE* lite connected thermostat, visit our how-to videos at: www.daikincomfort.com.

Add location name and address to the *SkyportHome* app

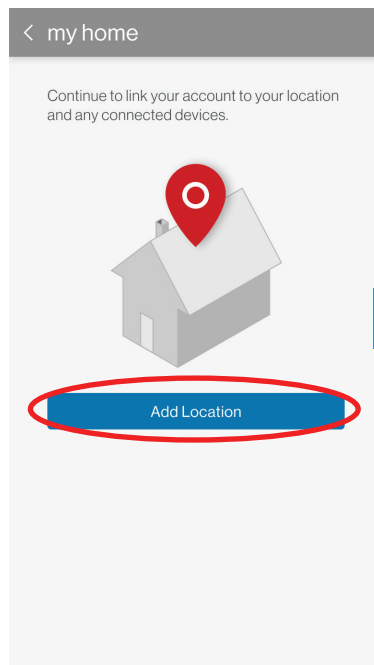

OR

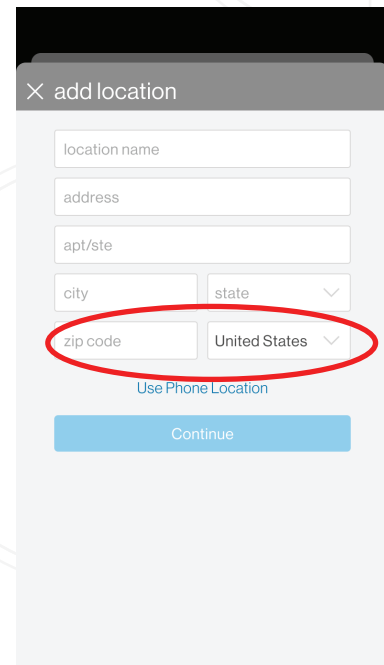
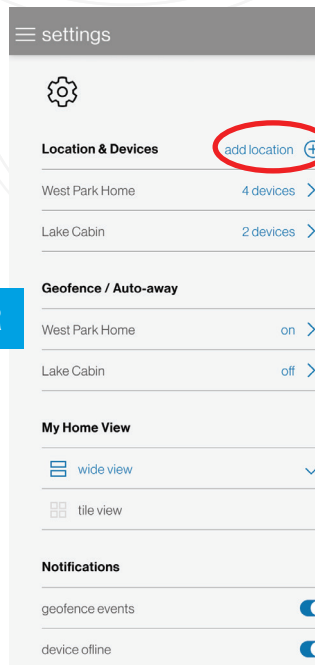

1. After creating a *SkyportHome* account, you will be prompted to add a location. If you already have a location and want to add another, select "add location" on the "settings" screen.

2. Enter the location name and address, then select "Next".

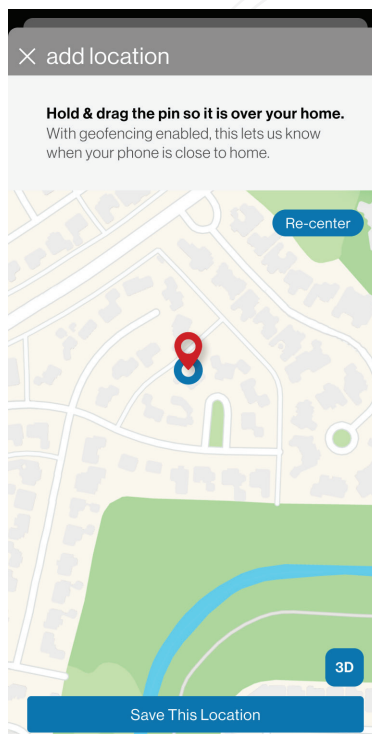

3. Verify the location address on the map. Move the pin to the correct location if needed, then select "Save This Location."

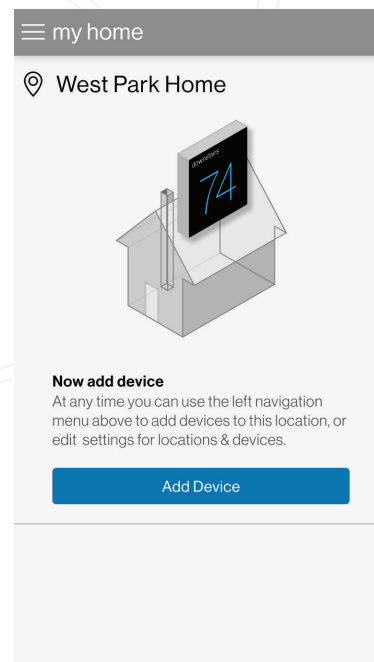

4. You will be navigated to the "my home" page where you can add a thermostat.

Connect thermostat to Wi-Fi using the *SkyportHome* app

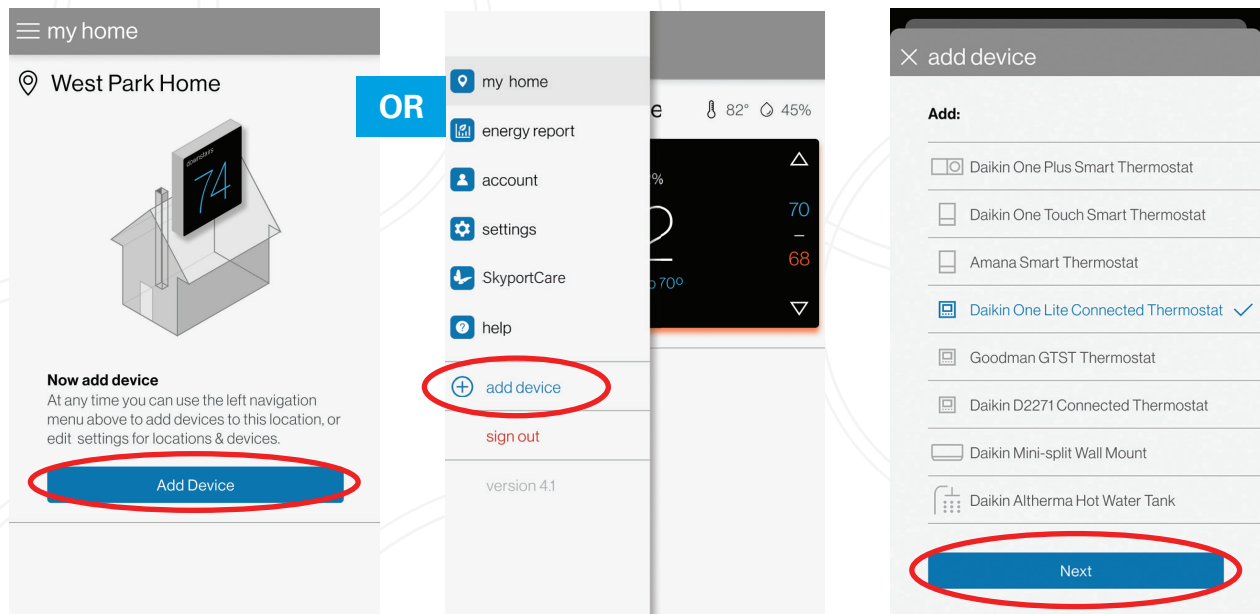

1. After creating a *SkyportHome* account and adding a location, select "Add Device" to add a thermostat. If you already have at least one thermostat, select "add device" found in drop down menu at the top left of the "my home" screen.
2. Select "**Daikin ONE lite connected thermostat**" from the list, select a location, and press "Next".

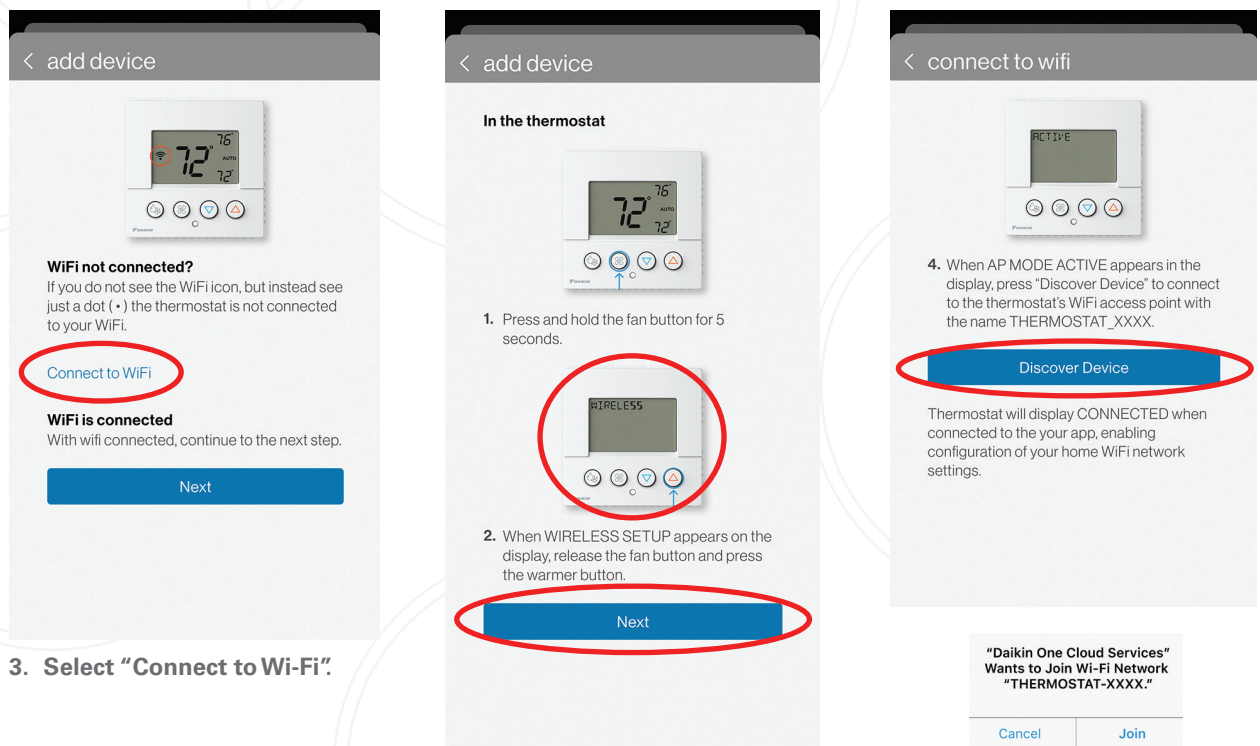

3. Select "Connect to Wi-Fi".

4. Press the fan button for 5 seconds to put the thermostat in "WIRELESS SETUP", then select "Continue".

5. Select "Discover Device" and allow the Daikin app to join the thermostat's Wi-Fi network.

Connect thermostat to Wi-Fi using the *SkyportHome* app (Continued)

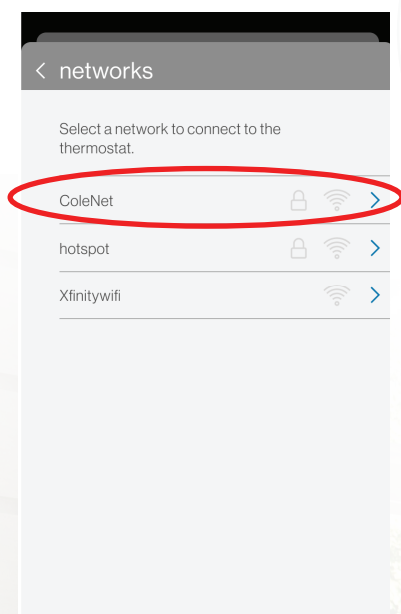

6. Select the appropriate Wi-Fi network from the list.

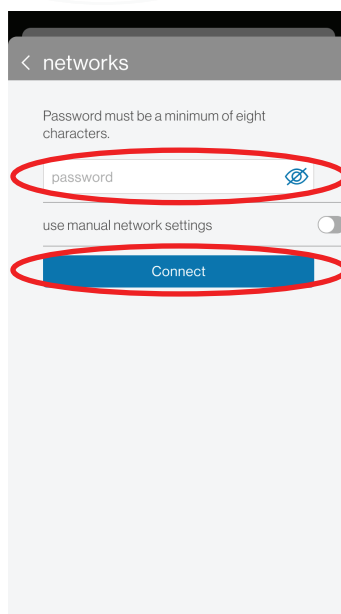

7. Enter the password and select "Connect".

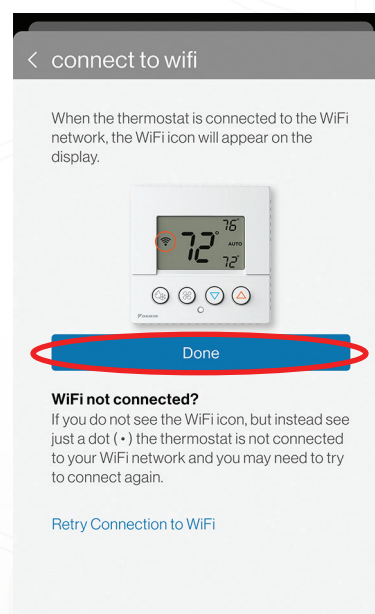

8. Confirm that the Wi-Fi icon appears on the thermostat screen, then select "Finish".

Connecting to the *SkyportHome* app

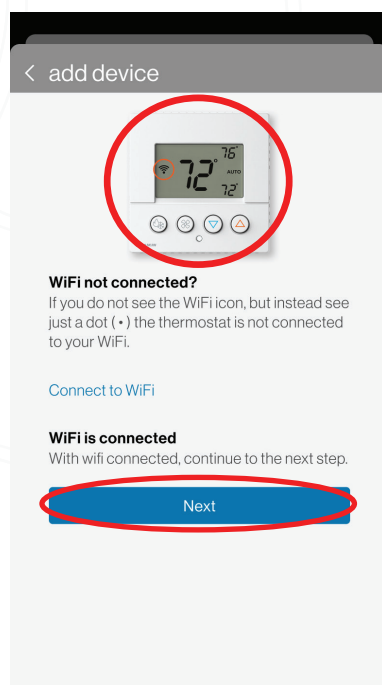

1. After your Daikin *ONE* Lite thermostat is connected to Wi-Fi, select "Next". (If not starting on this screen, select "Add Device", then select "Daikin *ONE* lite connected thermostat" and a location, and press "Next".)

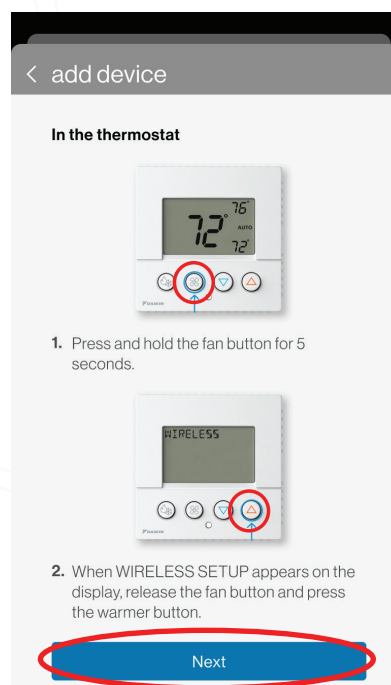

2. Press and hold the fan button on the thermostat for 5 seconds to put the thermostat in "Wireless Setup" mode. Then press the up/warmer button on the thermostat to display the 6-digit pairing code and select "Next".

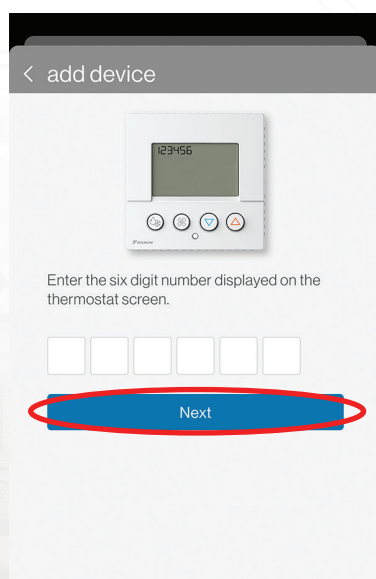

3. Enter the pairing code and select "Add" on your *SkyportHome* App.

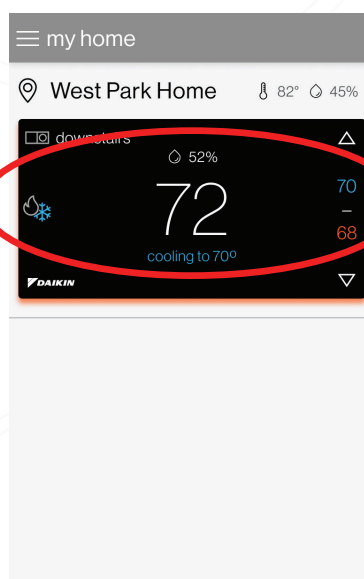

4. Confirm that the newly added thermostat appears on the "My Home" screen.

You are now able to access your Lite thermostat from your phone using the *SkyportHome* App!

Thermostat Interface Overview

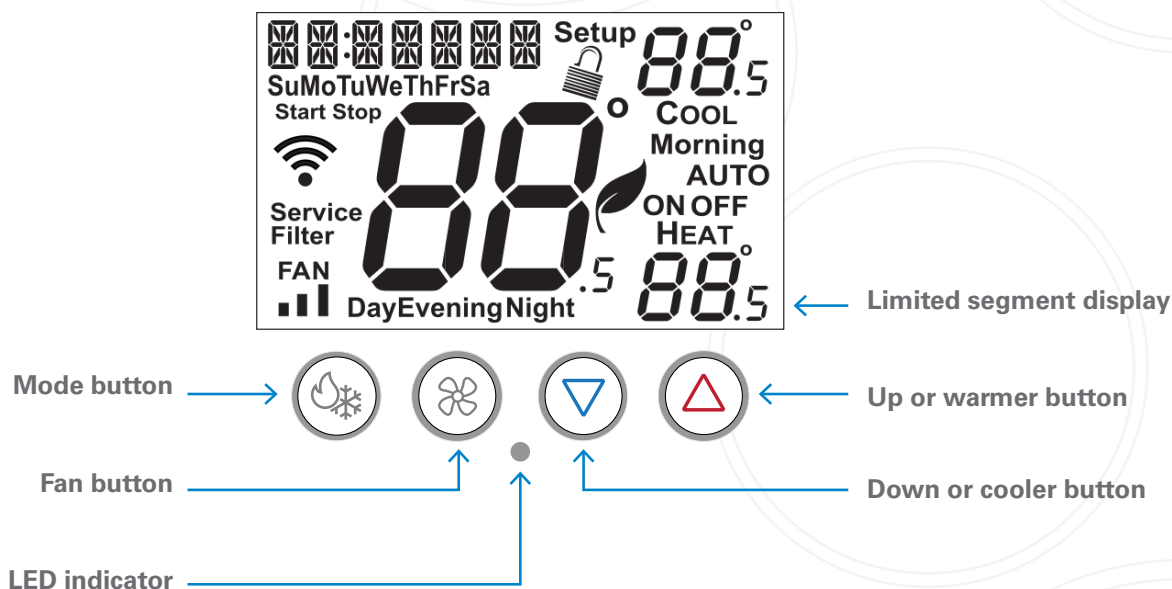

Mode Selection

On-screen display

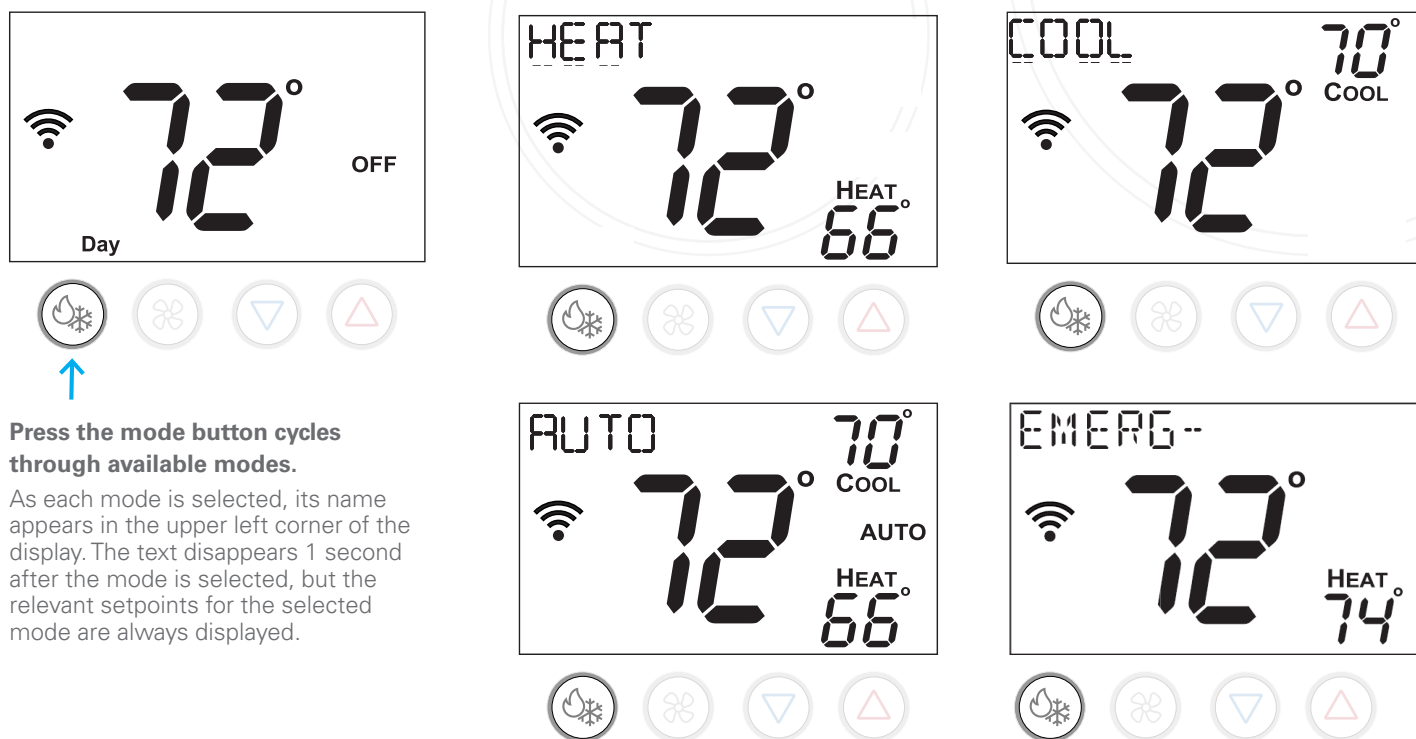

Adjusting the Setpoint

Increasing the temperature

Press the warmer (up) arrow button to raise the setpoint.

Decreasing the temperature

Press the cooler (down arrow button to lower the setpoint.)

Raising and lowering the setpoint

Button presses raise and lower the temperature by 1 degree when using Fahrenheit degree units. When using Celsius the temperature changes in 0.5 degree steps.

Note: For cool only mini and multi-split systems, heat mode, auto mode, emergency heat mode, and all heat setpoints including those for away mode and schedule mode are hidden.

Off mode

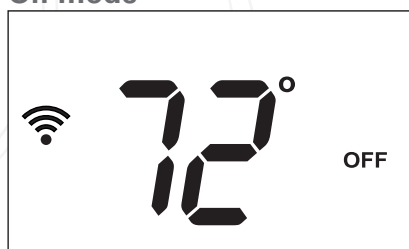

Pressing the warmer (up) and cooler (down) buttons has no effect when the system is off.

Heat or cool mode



When set to heat or cool modes, pressing the warmer (up) arrow button raises the setpoint. Pressing the cooler (down) arrow button lowers the setpoint.

Auto mode

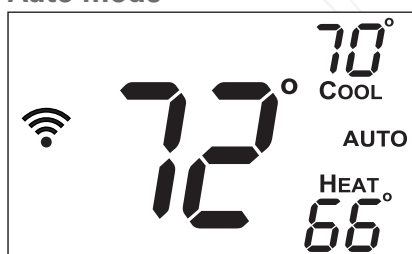

When set to auto mode, pressing the warmer (Up) up arrow button increases both the heat and cool setpoints. Pressing the cooler (down) arrow button decreases both the heat and cool setpoints.

To adjust heat or cool setpoints individually, switch to heat or cool mode, adjust the setpoint, and then return to auto mode.

When either the cool or heat setpoints hit the top/bottom of the scale the other setpoint will continue to adjust until the minimum difference between setpoints is hit.

Schedule mode



When the schedule is enabled, the warmer (up) and cooler (down) buttons raise and lower the setpoints as usual. Adjustments made this way remain in place until the next schedule event is reached.

For example, if a schedule has been set to heat to 68°F during the day period and 72°F during the evening period, changing the setpoint to 74°F at 4pm will override the day schedule. When the evening period begins, the system will revert back to the scheduled 72°F.

Setting Fan Settings*

*Fan settings can be changed more easily on the air quality screen of the *SkyportHome* app.

Primary display

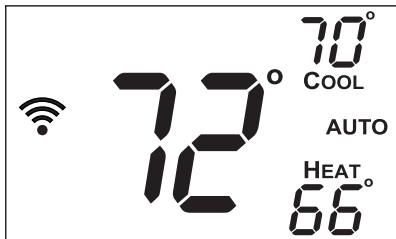

- » Pressing the fan button on the thermostat will turn the fan on and off.
- » Press and hold the fan button for 2 seconds to access the fan settings. Next, press either the mode or fan button to advance through each of the fan settings.
- » For the cool and heat fan speeds, press the up and down buttons to cycle through the available fan speeds of auto and 1 (low) through 5 (high).
- » The cool and heat louver position settings are available for indoor units that support these settings. When the vertical or horizontal louver swing is turned on, the louvers will oscillate in the relevant direction. A fixed direction can be set by turning the appropriate swing setting off when the louvers are in the desired position.
- » Press and hold the mode button for 2 seconds at any time to exit the home screen. The system will return to the home screen automatically after 2 minutes of inactivity.

Cool Fan Speed

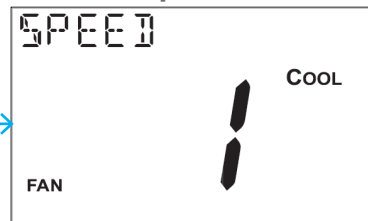

Press the warmer (up) and cooler (down) buttons to cycle through the available fan speeds of auto and 1 (low) through 5 (high).

Cool Vertical Swing

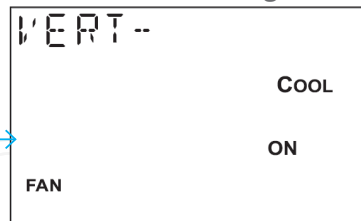

Press the warmer (up) and cooler (down) buttons to toggle the cool mode vertical swing off and on.

Cool Horizontal Swing

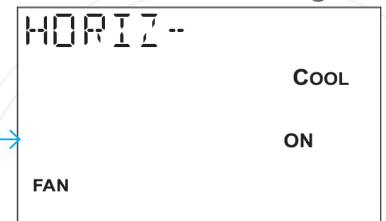

Press the warmer (up) and cooler (down) buttons to toggle the cool mode horizontal swing off and on.

Heat Fan Speed



Press the warmer (up) and cooler (down) buttons to cycle through available fan speeds of auto and 1 (low) through 5 (high).

Heat Vertical Swing

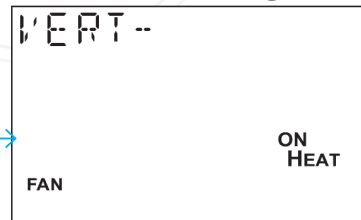

Press the warmer (up) and cooler (down) buttons to toggle the heat mode vertical swing off and on.

Heat Horizontal Swing

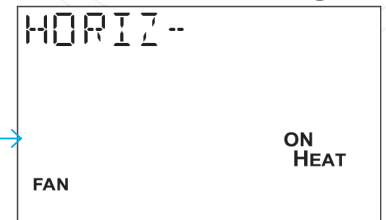

Press the warmer (up) and cooler (down) buttons to toggle the heat mode horizontal swing off and on.

Press the fan button to return to the home screen.

Setting the Schedule* (Continued)

*Setting up a daily schedule can be accomplished more easily using the *SkyportHome* app.

- » A schedule automatically uses different heat and/or cool setpoints for different days of the week and different periods of each day.
- » The schedule repeats each week, and can have up to 4 schedule events per day, each with its own heat and cool setpoints.

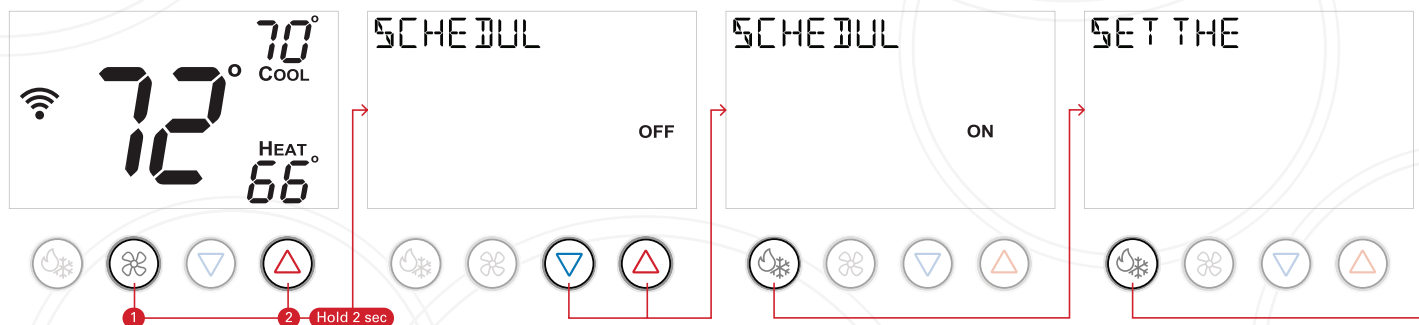

Press and hold the fan and warmer (up) buttons for 2 seconds to enter schedule mode for programming a schedule. While in schedule mode, press the mode button to advance through each setting for each day of the week and each time period of each day.

To exit schedule mode and return to the home screen at any time, press and hold the mode button for 2 seconds. The system will return to the home screen automatically after 2 minutes of inactivity.

Schedule Instructions

Press the warmer (up) button and cooler (down) button to toggle the schedule on and off.

Schedule Instructions

Press the mode button to advance to the next step.

Schedule Instructions

Press the mode button to advance to the next step.

Setting the Schedule *(Continued)*

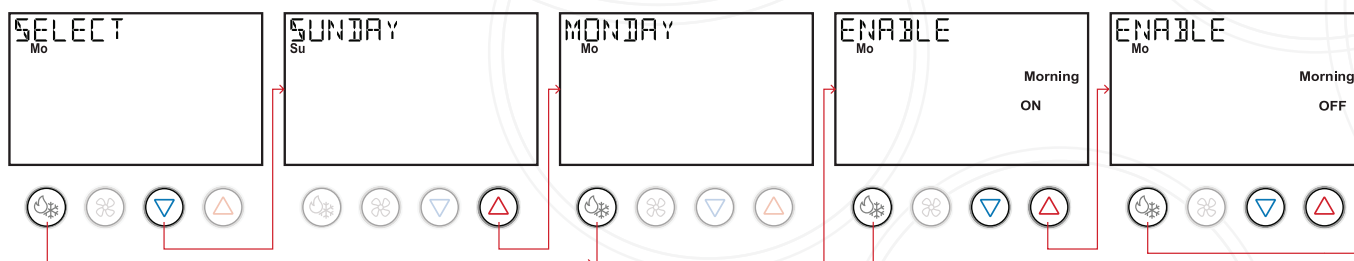

Choose day of the week instructions.

Press the mode button to advance to the next step for selecting a day of the week.

Choose day of the week.

Press the warmer (up) button to select the next day of the week, or the cooler (down) button to select the previous day.

Press the mode button to advance to the next step.

Enable Morning event

Press the warmer (up) button or the cooler (down) button to toggle the morning schedule event for this day on and off. With the morning schedule event on (enabled) press the mode button to proceed to the next step for selecting the event start time.

Disable morning event

Press the warmer (up) or cooler (down) buttons to adjust the morning schedule event start time in 15 minute increments. The day of the week being scheduled appears below the time selection, and the name of the schedule event ("morning" in this case) also appears on the screen. Press the mode button to advance to the next step.

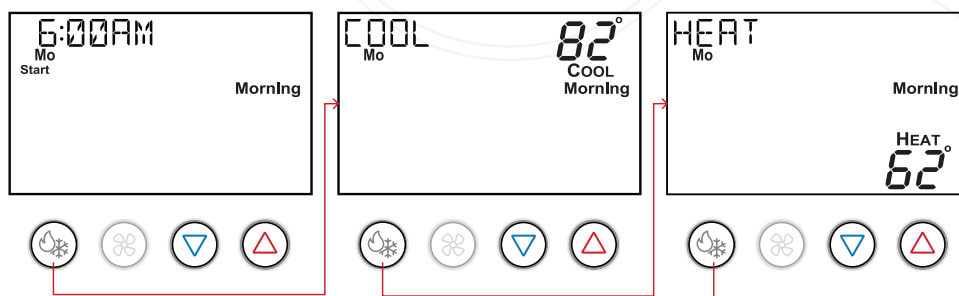
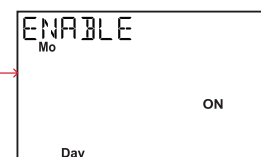

Set morning event cool setpoint.

Warmer (up) and cooler (down) buttons adjust the setpoint.

The day of the week being scheduled appears below the "Cool" text.

Setting the Schedule *(Continued)*

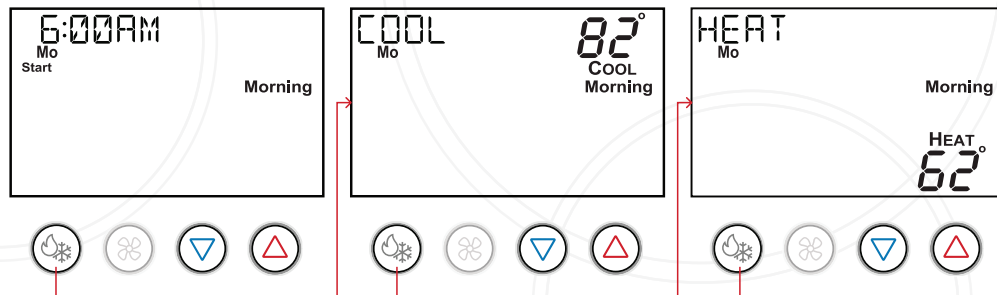

Press the warmer (up) or cooler (down) buttons to adjust the morning schedule event start time in 15 minute increments. The day of the week being scheduled appears below the time selection, and the name of the schedule event ("morning" in this case) also appears on the screen. Press the mode button to advance to the next step.

Press the warmer (up) or cooler (down) buttons to adjust the cool setpoint for the morning schedule event. Press the mode button to advance to the next step.

Press the warmer (up) or cooler (down) buttons to adjust the heat setpoint for the morning schedule event. Press the mode button to advance to the next step.

Repeat steps for day event.

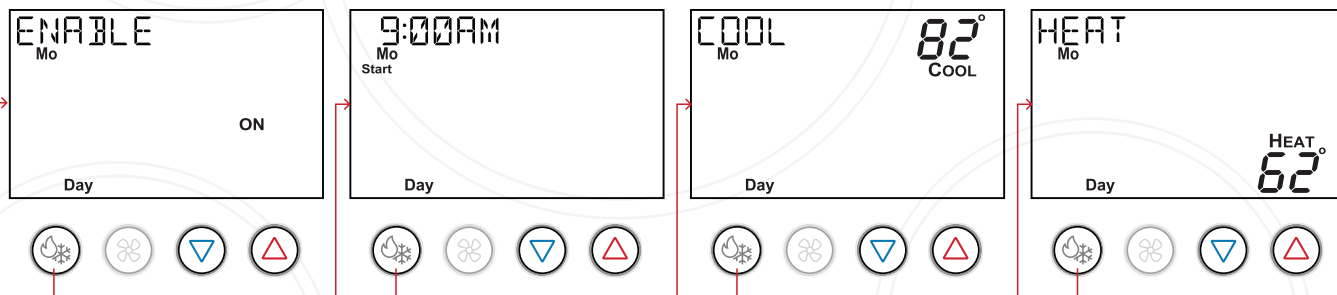

Enable day event.

Set day event start time.

Set day event cool setpoint.

Set day event heat setpoint.

Repeat steps for "evening" event.

Setting the Schedule *(Continued)*

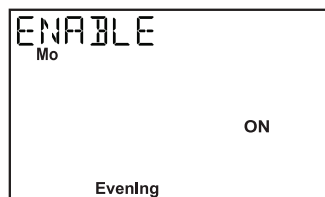

Enable evening event.

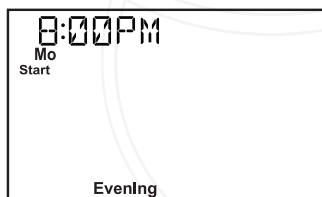

Set evening event start time.

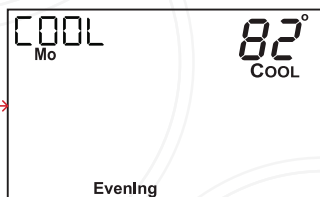

Set evening event cool setpoint.

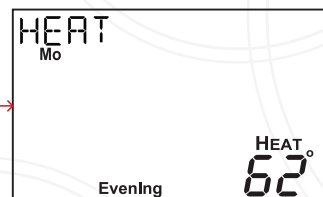

Set evening event heat setpoint. Repeat steps for night event.

Enable evening event.

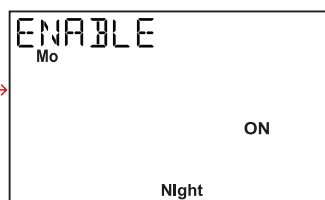

Enable night event.

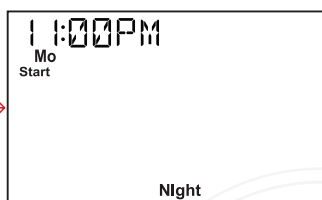

Set night event start time.

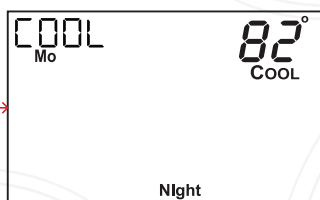

Set night event cool setpoint.

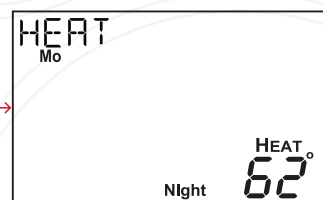

Set night event heat setpoint. Next press the mode button again to complete this day's schedule and advance to the next step to either select another day to schedule or to copy this day's schedule to another day.

Setting the Schedule *(Continued)*

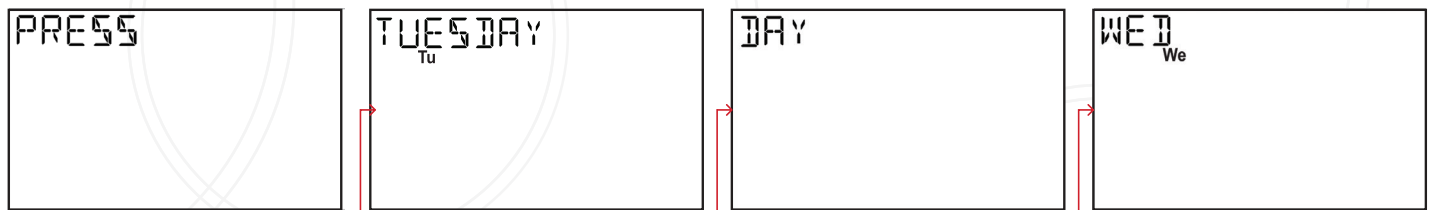

Press the mode button to copy Monday's schedule to Tuesday, or use the warmer (up) and cooler (down) buttons to select another day to copy Monday's schedule to.

After copying Monday to Tuesday, pressing the warmer (up) button to select another day to copy to, or press the mode button to program another day

Continue to copy to as many days as wanted.

Copy day

Press the mode button to return to the screen for selecting another day of the week to schedule, or press the warmer (up) button to copy the current day's schedule to another day.

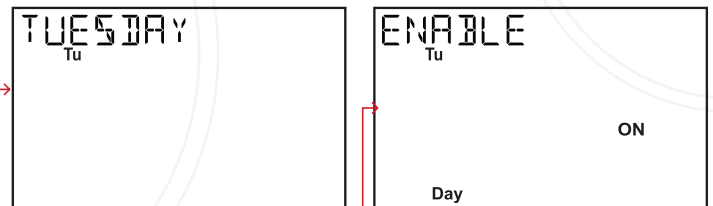

Choose day of the week.

Warmer (up) button selects the next day, cooler (down) button selects the previous day.

Continue programming individual days.

Setting Away Setpoints

Setting away setpoints

The Away setpoints allow you to save energy by limiting heating and cooling when you are away from home. The Away setpoints are also used when geofencing is enabled in the *SkyportHome* App, and can be more easily setup in the app.

- » **Press the Warmer (up) button** and cooler (down) buttons to enter the settings for Away mode.
- » **Press the the mode button** to advance through the away mode settings, and use the warmer (up) and cooler (down) buttons to change each setting.
- » **To exit to the home screen at any time**, press and hold the mode button for 2 seconds.
The system will return to the home screen automatically after 2 minutes of inactivity.

Primary Display

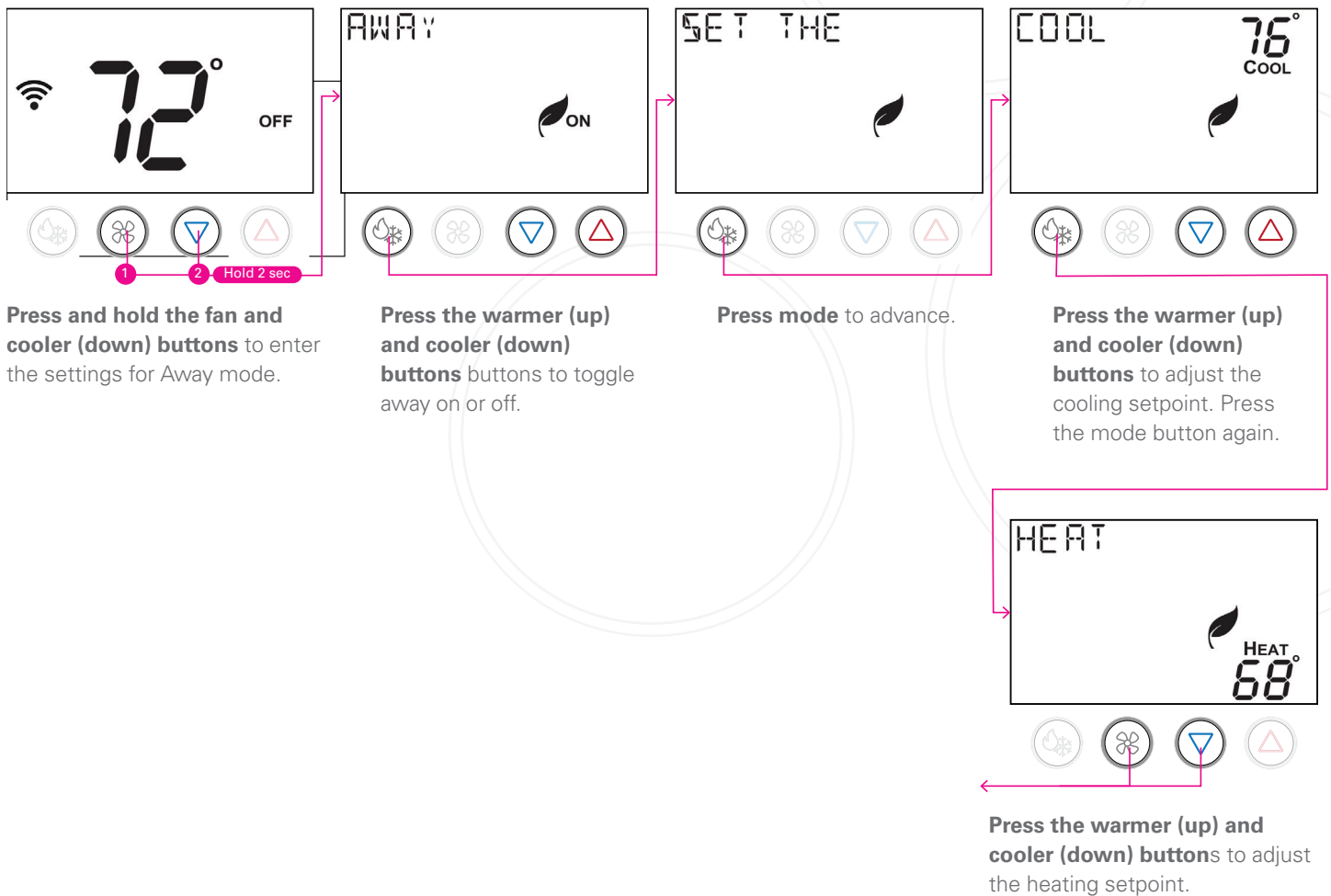

Locking/Unlocking the Keypad

Setting the daily schedule

To prevent unauthorized use of the thermostat, the front panel buttons may be disabled by locking them.

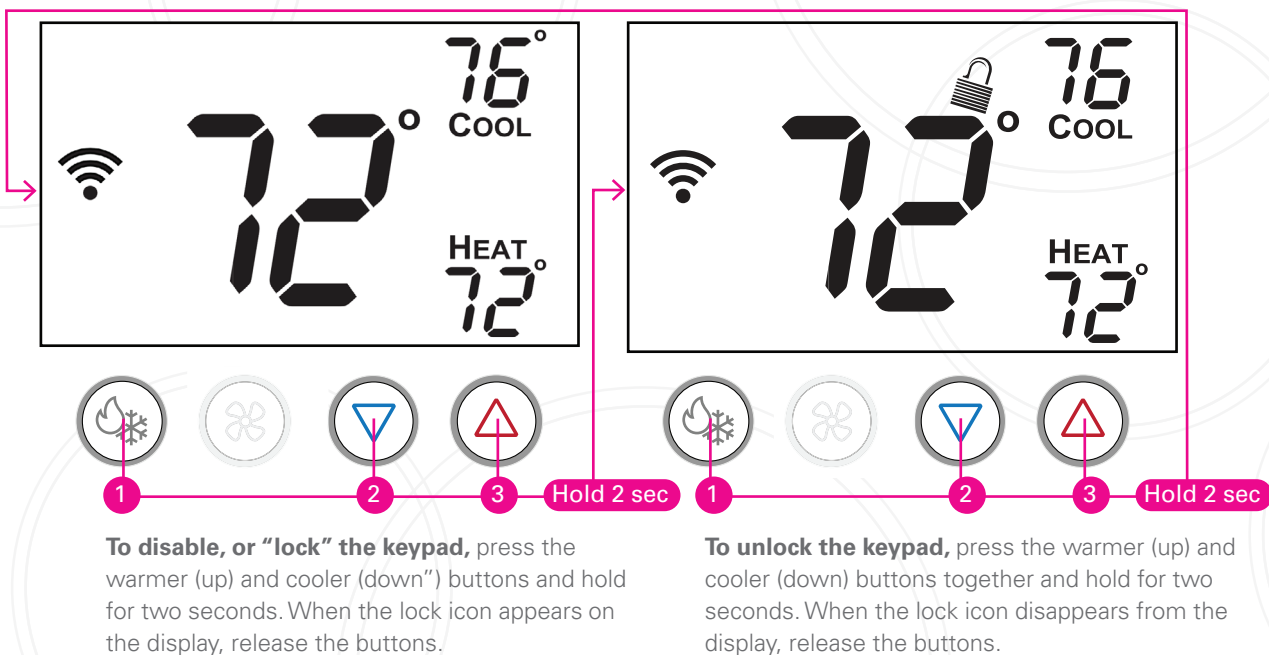

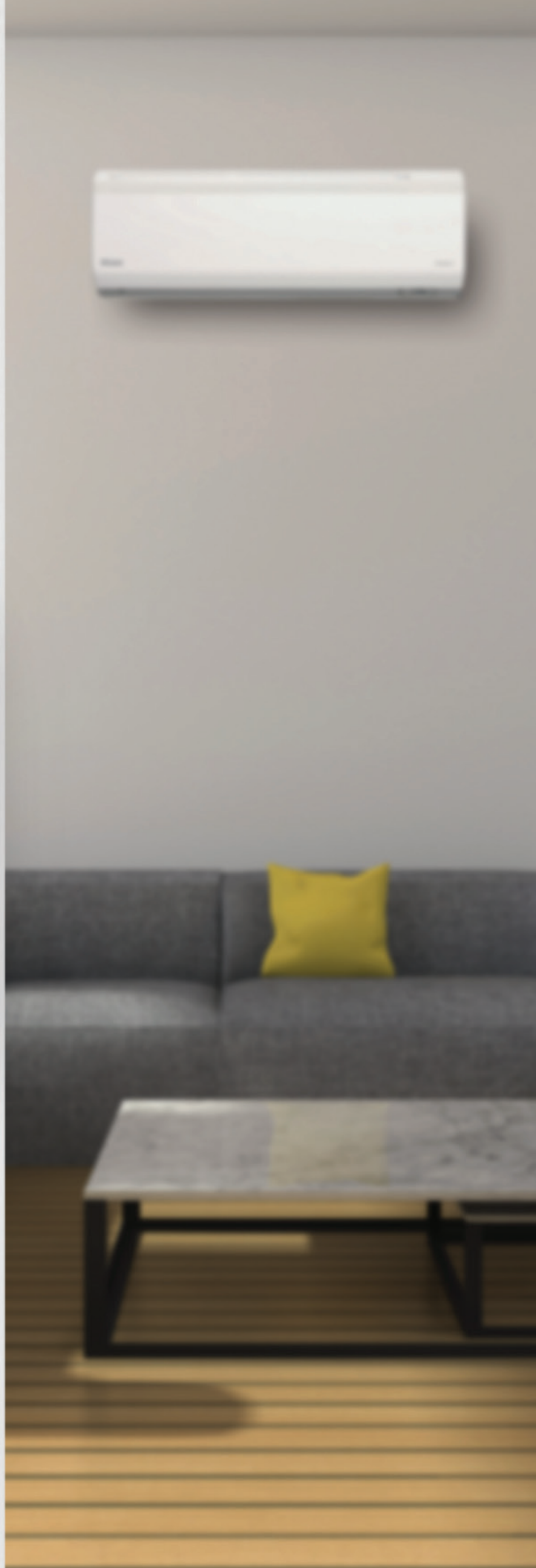

Important Notes

NOTE:

This device complies with Part 15 of the FCC Rules. Operation is subject to the following two conditions: (1) this device may not cause harmful interference, and (2) this device must accept any interference received, including interference that may cause undesired operation. Changes or modifications not expressly approved by Daikin could void the user's authority to operate the equipment.

This equipment has been tested and found to comply with the limits for a Class B digital device, pursuant to part 15 of the FCC Rules. These limits are designed to provide reasonable protection against harmful interference in a residential installation. This equipment generates uses and can radiate radio frequency energy and, if not installed and used in accordance with the instructions, may cause harmful interference to radio communications. However, there is no guarantee that interference will not occur in a particular installation. If this equipment does cause harmful interference to radio or television reception, which can be determined by turning the equipment off and on, the user is encouraged to try to correct the interference by one or more of the following measures:

- » Reorient or relocate the receiving antenna.
- » Increase the separation between the equipment and receiver.
- » Connect the equipment into an outlet on a circuit different from that to which the receiver is connected.
- » Consult the dealer or an experienced radio/ TV technician for help.

This device contains license-exempt transmitter(s)/receiver(s) that comply with Innovation, Science and Economic Development Canada's license-exempt RSS(s). Operation is subject to the following two conditions:

1. This device may not cause interference.
2. This device must accept any interference, including interference that may cause undesired operation of the device.

REMARQUE:

Cet équipement a été testé et déclaré conforme aux limites imposées aux appareils numériques de classe B, conformément à la section 15 du règlement de la FCC. Ces limites sont conçues pour fournir une protection raisonnable contre les interférences nuisibles dans une installation résidentielle. Cet équipement génère, utilise et peut émettre des fréquences radio et, s'il n'est pas installé et utilisé conformément aux instructions, il peut causer des interférences nuisibles aux radiocommunications. Cependant, rien ne garantit que des interférences ne se produiront pas dans une installation particulière. Si cet équipement provoque des interférences nuisant à la réception de la radio ou de la télévision, ce qui peut être déterminé en éteignant et en rallumant l'équipement, l'utilisateur est invité à tenter de corriger les interférences en appliquant l'une ou plusieurs des mesures suivantes:

- » Réorienter ou déplacer l'antenne de réception.
- » Augmenter la distance entre l'équipement et le récepteur.
- » Connecter l'équipement à une prise d'un circuit différent de celui auquel le récepteur est connecté.
- » Consulter le concessionnaire ou un technicien expérimenté en radio/télévision pour obtenir de l'aide.

L'émetteur/récepteur exempt de licence contenu dans le présent appareil est conforme aux CNR d'Innovation, Sciences et Développement économique Canada applicables aux appareils radio exempts de licence. L'exploitation est autorisée aux deux conditions suivantes:

1. L'appareil ne doit pas produire de brouillage;
2. L'appareil doit accepter tout brouillage radioélectrique subi, même si le brouillage est susceptible d'en compromettre le fonctionnement



FOR ADDITIONAL
RESOURCES AND
INSTRUCTIONAL VIDEOS,
SCAN CODE OR VISIT:

WWW.DAIKINCOMFORT.COM



If you encounter any issues or would like assistance with setting up your Daikin *ONE* lite connected thermostat, please contact Daikin support at **1-855-Daikin1** to be connected with our thermostat support team.

ADDITIONAL INFORMATION

Before purchasing this appliance, read important information about its estimated annual energy consumption, yearly operating cost, or energy efficiency rating that is available from your retailer.



Our continuing commitment to quality products may mean a change in specifications without notice.

© 2025 DAIKIN COMFORT TECHNOLOGIES NORTH AMERICA, INC.

Houston, Texas · USA · www.daikincomfort.com

HG-ONELITE_09-25